

ProLine 2 - hand-held transmitters Innovation meets design

ProLine 2 – bidirectional radio system for roller shutters and sun protection systems



Visit our homepage! There we will show you the advantages of bidirectional radio with the help of an easy to understand 3D animation.

Overview of functions ProLine 2 - hand-held transmitters

	MonoTel 2	LumeroTel 2	VarioTel 2	TempoTel 2
Suitable for:				
Roller shutters	●	●	●	●
Awnings/roller blinds	●	●	●	●
Venetian blinds	●	●	●	●
Lighting/heating	●	●	●	●
Can be used as:				
Individual control	●	●	●	●
Group control	●	●	●	●
Central control	●	●	●	●
Functions:				
Manual/auto switching of each channel		●	●	●
Up-stop-down buttons	●	●	●	●
Multi-channel transmitter			●	●
Astro programme with adjustable time shift			●	●
Pre-selected switching times can be set for each channel			●	●
Multiple languages selectable			●	●
Intermediate position	●	●	●	●
Ventilation position	●	●	●	●
Tilting position / fabric tension	●	●	●	●
Holiday programme			●	●
Automatic summer/winter time changeover			●	●
Run time setting			●	●
New functions:				
Feedback display of reception	●	●	●	●
Feedback display of a malfunction/function lock due to alarm	●	●	●	●
Feedback display of the manual/auto status		●	●	●
Feedback display of the position			●	●
Channel-by-channel setting of switching times			●	●
Menu-driven navigation			●	●
Menu-driven group assignment			●	●
Channel assignment according to rooms/groups with naming			●	●
Compatible to elero unidirectional radio products	●	●	●	●
Standard colours: pure white, silver, titanium grey	●	●	●	●
Magnetic wall holder included	●	●	●	●
Standard batteries 2 x LR06 (AA) included	●	●	●	●

Technical parameters subject to change. GB-13 600.4801/0809



Wissen was läuft!
Knowing what's up!
ProLine 2



Your elero specialist supplier:

Always on the safe side with bidirectional radio!

ProLine 2 – new hand-held transmitters for maximum operating comfort



ProLine 2 – everything's under control

Each of the four new hand-held transmitters can be used for roller shutters and sun protection systems of all kinds as well as for ProLine heating and lighting controllers. Particular importance was placed on developing transmitters that combine innovative and ergonomic design with easy and intuitive operation. The hand-held transmitters are supplied as standard with a magnetic wall holder and are available in the colours pure white, silver and titanium grey. The MonoTel 2, LumeroTel 2, VarioTel 2 and TempoTel 2 represent a new generation of hand-held transmitters designed to provide modern control solutions for the widest variety of applications and for all user profiles.

ProLine 2 - the intelligent bidirectional radio system

Thanks to ProLine 2, the new bidirectional radio system from elero, roller shutters, awnings, roller blinds and venetian blinds can be controlled more reliably, more efficiently and more transparently than using unidirectional radio standards. At the heart of the new technology (868 MHz) are bidirectional radio receivers (transceivers) that are capable not only of receiving, but also of confirming and relaying the signals.

Efficient, reliable and extremely versatile!

Intelligent network routing ensures that radio signals are relayed via a replacement route, i.e. via another bidirectional radio receiver, if the direct route to the drive is interrupted, e.g. due to reflective walls or obstacles. Up to five 'hops' are possible in this manner.

Innovative technology packed into a new design!

Four new hand-held transmitters with a modern, ergonomic design have been developed: The MonoTel 2, LumeroTel 2, VarioTel 2 and TempoTel 2 hand-held transmitters are compatible with elero unidirectional radio products and can therefore be integrated in existing radio systems without problem. The programming and operation are virtually identical to those of preceding models. Unidirectional radio receivers, sensors and wall-mounted devices will be successively adapted to the bidirectional system.

More safety and transparency for the user!

A further decisive advantage over other radio systems is the fact that the user can read off the signal processing status directly on the hand-held transmitter. The user receives feedback as soon as a command is executed and therefore always knows what's up.

Pictorial illustration of the routing technology

Objective: Roller shutter no. 2 should be opened from another room.

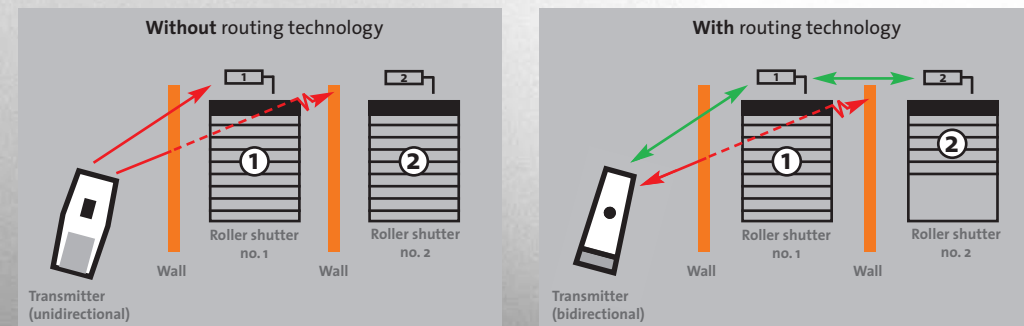

Result: Roller shutter no. 2 waits in vain due to obstacles and larger distance.

Result: Bidirectional radio receiver no. 1 can send the command to receiver no. 2 and open the roller shutter.



The command to extend the awning is sent to the receiver by pressing the Down button.

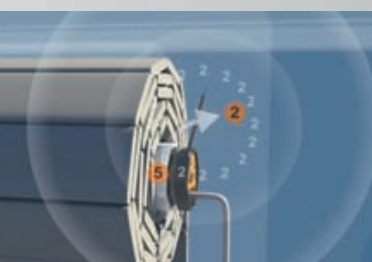

Another receiver routes the radio signal to the target address if the direct route is interrupted.

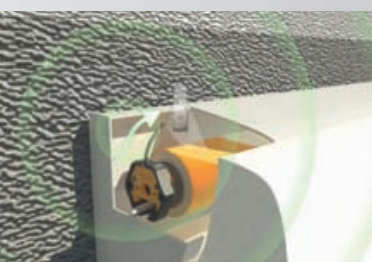

Reception is confirmed, the awning is extended and feedback is transmitted to the hand-held transmitter.



Feedback that the command is being executed and the awning extended can be read off from the hand-held transmitter.

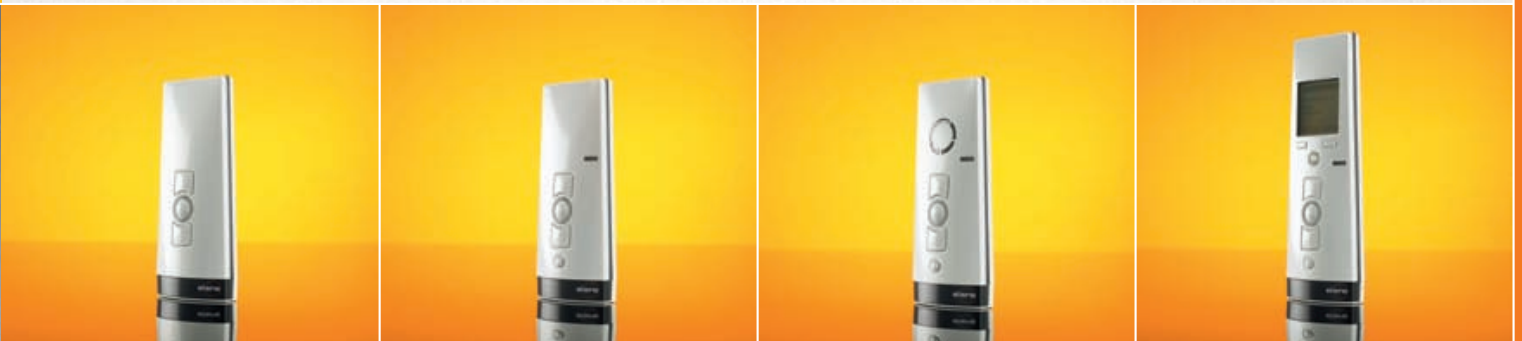

MonoTel 2

- Single-channel hand-held transmitter
- LED status display

LumeroTel 2

- Single-channel hand-held transmitter
- LED status display
- Select button for manual/auto switching with LED display

VarioTel 2

- Group hand-held transmitter
- 5 individual channels + 1 central channel
- LED status display
- Select button for manual/auto/channel switching with LED display
- Manual/auto function can be selected per channel

TempoTel 2

- Hand-held transmitter with display
- 10 individual channels, 2 group channels + 1 central channel
- LED status display
- Select button for manual/auto switching with LED and plain text display
- Illuminated display for menu navigation
- Convenient operation and channel selection via joystick
- Multiple languages selectable
- Astro and holiday programme
- Daily and weekly switching programme

The most important technical features:

- Intelligent network routing for higher reliability and performance
- Reliable transmission of radio signals (up to 5 'hops')
- Automatic telegram repetitions
- Direct feedback of the signal processing status to the hand-held transmitter
- Full downward compatibility to elero unidirectional radio products
- Use of the licence-free and interference-proof 868 MHz band
- No interference with DECT, WLAN and PMR systems

Advantages for the user:

- Hand-held transmitters and wall holders have an innovative design and are available in the colours pure white, silver and titanium grey
- Easy operation, large buttons and good ergonomics
- More safety thanks to clever and reliable technology
- Signal processing status can be read off directly from the hand-held transmitter, high transparency
- Low radio power (max. 10 mW) thanks to short transmissions
- 2 x LRO6 (AA) standard batteries can be used

